

Series:

Available
Tip Styles:

Ordering Description:

HFS-840 ...

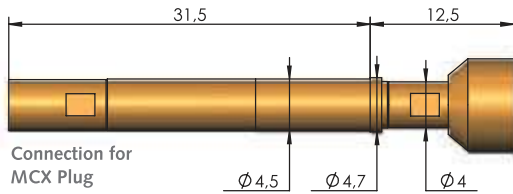

HFS-840 ... M (*)

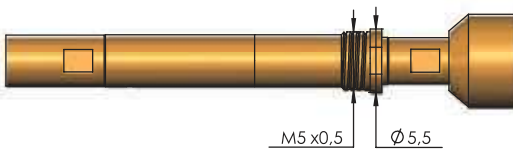

HFS-440 ...

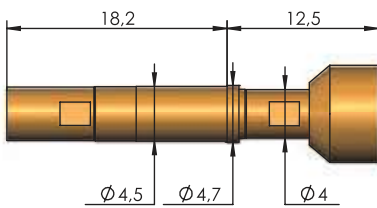

HFS-440 ... M (*)

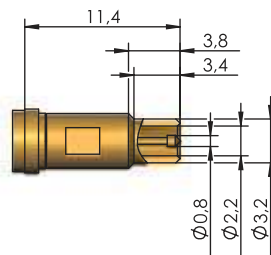
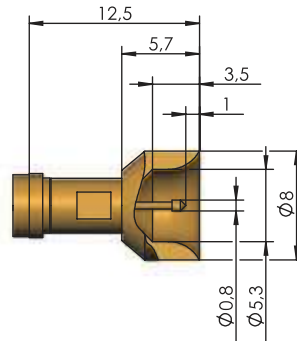
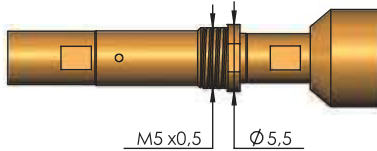

- HFS-840 308 080 A **xx** 43 X
- HFS-840 308 080 A **xx** 43 X M
- HFS-440 308 080 A **xx** 43 X
- HFS-440 308 080 A **xx** 43 X M

Note: Version with enlarged centering range. Outer conductor centers itself from the outer side on the Connector. Centering range: ± 1.4 mm

- HFS-840 308 080 A **xx** 42 X4
- HFS-840 308 080 A **xx** 42 X4 M
- HFS-440 308 080 A **xx** 42 X4
- HFS-440 308 080 A **xx** 42 X4 M

Note: Version with pre-centering on the inner side of the Connector Outer Contact. Centering range: ± 0.6 mm

Spring force rating

The spring-loaded Inner and Outer Conductors are available with different spring forces. The ordering description is derived by adding the individual values.

	HFS-840 HFS-840 M		HFS-440 HFS-440 M		
Spring Force of Inner Conductor (N)	1.3	2.0	1.3	2.0	1.0
Spring Force of Outer Conductor (N)	4.0	6.0	8.0	8.0	4.0
Character for ordering	53	80	93	99	50

Note: (*)

For usage in the case of vibration, shaking, snapping or assembly upside down.

Mechanical Data

HFS-840 and HFS-840 M

	Outer Cond.	Inner Cond.
Working Stroke:	4.0 mm	2.0 mm
Maximum Stroke:	5.0 mm	3.7 mm

Mechanical Data

HFS-440 and HFS-440 M

	Outer Cond.	Inner Cond.
Working Stroke:	2.0 mm	2.0 mm
Maximum Stroke:	3.0 mm	3.0 mm